

A+

WOOD STOVE SET

CENTRO

AVAILABLE DESIGN:

(1) Concrete slate



(1)

STANDARD SCOPE OF DELIVERY

- Complete wood stove set
- Set of elements made of lightweight concrete (Dispersion paint is mandatory!)
- Closing edge for flush mounted construction
- Possibility for external combustion air connection comes as standard
- Freestanding installation possible

Please order the connecting piece for external air

Large glass door



Elements made of lightweight concrete (painting is mandatory!)



Centro, mantel concrete slate

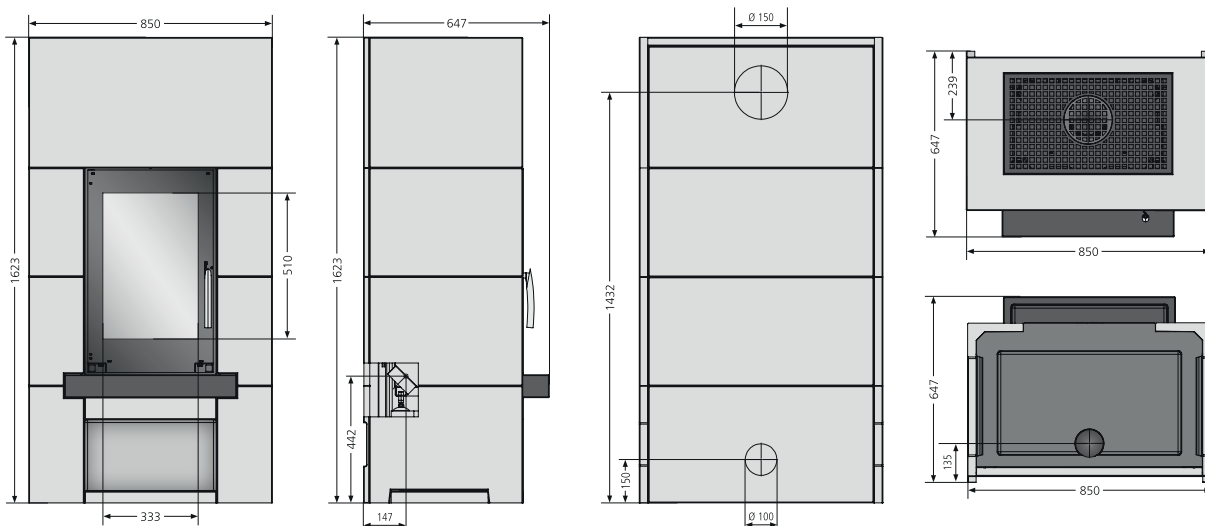

24h

144 m³

>82 %



33cm



Available design	Order no.	EAN-Code
Centro, mantel concrete slate	4801 90	4250340907637
Optional accessories	Order no.	EAN-Code
Connecting piece for combustion air supply	9200 69	4029807779991

Energy efficiency class		A+
Connection possibility		top / rear
Operation with external air supply		rear / bottom
Nominal heat output	kW	7,0
Weight (incl. packaging)	ca. kg	473
Room heating capability	m ³	144
Length of logs	cm	33
Exhaust gas mass flow	g/s	7,0
Exhaust gas temperature	° C	308
Required discharge pressure	mbar	0,12

Illustrations are given as indications only. Optical deviations are no defect.

JUSTUS